

AIR POWER



APEX ELITE
Owners Manual



AIR POWER

APEX ELITE
Manual Contents

Safety Precautions

Description And Operation

Loading And Firing

Disassembly And Cleaning

Shock Buffer

Recharging CO₂ Cylinder

Parts List

Repair

Warranty Information

THE INFORMATION IN THIS MANUAL IS SUBJECT TO CHANGE WITHOUT NOTICE. THIS MANUAL DOES NOT REPRESENT A COMMITMENT ON THE PART OF AIR POWER ENTERPRISES INC. AIR POWER RESERVES THE RIGHT TO MAKE IMPROVEMENTS TO THE PRODUCTS WITHOUT OBLIGATION TO IMPROVE ANY PRODUCTS PREVIOUSLY SOLD.

COPYRIGHT © AIR POWER ENTERPRISES INC. 1990

Safety Precautions

WARNING!

THE APEX ELITE IS NOT A TOY. ADULT SUPERVISION REQUIRED. MISUSE OR CARELESS HANDLING MAY CAUSE SERIOUS INJURY OR DEATH. USE PROPER .68 CALIBER PAINT PELLETS ONLY. READ ALL INSTRUCTIONS BEFORE USING. THIS IS A HIGH POWER CO₂ GAS GUN INTENDED FOR USE BY ADULTS ONLY. NOT INTENDED FOR USE BY PERSONS UNDER THE AGE OF 18.

FIREARM SAFETY RULES SHOULD BE FOLLOWED

Do not handle this paintgun until you are thoroughly familiar with its mechanical and handling characteristics.

Engage the CO₂ cylinder only while the gun is in use.

Unload it completely after use.

Always engage the safety when not in use.

Never look directly into the barrel. Accidental discharge can cause permanent injury or death.

Use only .68 caliber paint pellets. Do not substitute any foreign objects for use as ammunition.

Do not attempt to service the gun without disengaging the CO₂ gas cylinder first.

When using this paintgun always wear protective eyewear.

WARNING!

NEVER AIM AT ANYTHING WHICH YOU DO NOT WISH TO SHOOT. ALWAYS KEEP THE MUZZLE POINTING IN A SAFE DIRECTION. BE SURE OF YOUR INTENDED LINE OF FIRE BEFORE SHOOTING.

WARNING!

THIS PAINTGUN HAS BEEN TESTED WITH .68 CALIBER PAINT PELLETS AND IS FOUND TO PERFORM TO STANDARD SPECIFICATIONS. IT IS INTENDED FOR USE WITH PAINT PELLETS ONLY. WE SPECIFICALLY DISCLAIM ANY RESPONSIBILITY FOR ANY DAMAGE OR INJURY WHAT SO EVER OCCURRING IN CONNECTION WITH THE USE OF ANY FAULTY OR NON-STANDARD OR ILLEGAL PROJECTORIES.

WARNING!

ALWAYS WEAR SAFETY EYE PROTECTION WHEN USING THIS PAINTGUN. WE SPECIFICALLY DISCLAIM ANY DAMAGE OR INJURY RESULTING FROM NON USAGE OF SAFETY EYEWEAR OR FROM DAMAGE OR INJURY RESULTING FROM NON-STANDARD EYEWEAR.

WARNING!

THIS PAINTGUN HAS BEEN THOROUGHLY TESTED AND INSPECTED PRIOR TO SHIPMENT AND WE ASSUME NO RESPONSIBILITY OR LIABILITY FOR ANY INJURY OR DAMAGES FROM ITS INTENTIONAL OR ACCIDENTAL DISCHARGE.

Description And Operation

Thank you for selecting the Air Power APEX ELITE marking Paintgun.

The APEX ELITE is a CO₂ powered paintgun designed to give the user optimum performance and accuracy when marking desired objects.

The APEX ELITE is a gravity fed, pump action .68 caliber marking gun.

The heart of the APEX ELITE is the Venturi Bolt. Six jets at the face of the Venturi Bolt control gas flow giving the APEX ELITE longer more accurate shots.

Specifications

Power Source: 7 oz. or 10 oz. rechargeable CO₂ cylinder

Loading Mechanism: gravity feed, pump action

Weight: 4.5 pounds with 7 oz. cylinder

Barrel Length: 12 inches from bolt face

Overall Length: 29.5 inches

Safety: Trigger Block

Standard Features

"Auto Trigger"

Die Cast Receiver

Self Centering Hammer

Sling Kit

Choice Of Box Or Tube Magazine

Over Travel Adjustment On Trigger

Loading And Firing

Always point muzzle in a safe direction. Use caution at all times, refer to safety warnings. Use only .68 caliber paint pellets

1. Engage trigger safety by pushing switch to right.
2. Engage CO₂ cylinder by turning it clockwise.
3. Load paint pellets into magazine.
4. Slide pump handle back and forward full stroke.
5. Disengage safety switch.
6. Paintgun is now ready to fire.
7. Aim at desired target and fire.

Firing In Auto Trigger Mode

1. Hold auto trigger in firing position.
2. Pump handle back and forth using full strokes as quickly as you can.
3. Gun will fire each time pump is fully cycled.
4. Take care not to pinch paint pellets while in auto trigger mode.
5. Auto trigger is useful when rapid firing is desired.

Unloading And Storage

1. Always remove paint pellets and disengage CO₂ cylinder.
2. Store in a dry place, away from children and in a safe area.
3. Never store a loaded paintgun.
4. Always engage safety when not in use.

Disassembly And Cleaning

1. Disengage CO₂ cylinder. Remove by turning cylinder towards the left.
2. Pull off magazine from barrel assembly.
3. Remove receiver.
4. APEX ELITE should appear as in Figure 1.

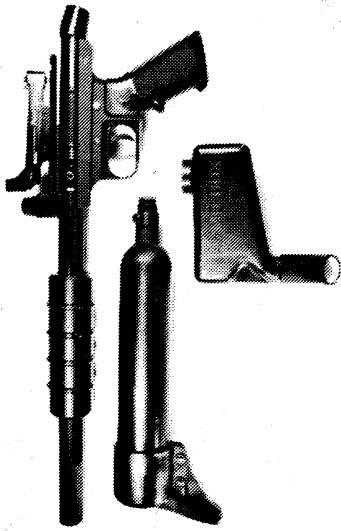

Figure 1

5. Remove pump screw and shock buffer as in Figure 2.

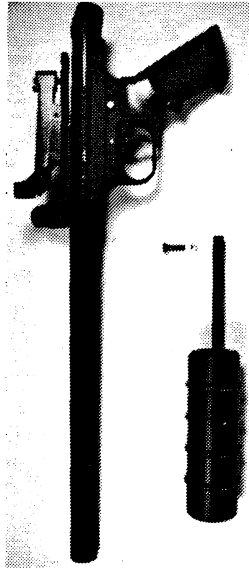

Figure 2

6. Remove adaptor assembly as in Figure 3.



Figure 3

7. Remove bolt and hammer assembly as in Figure 4.

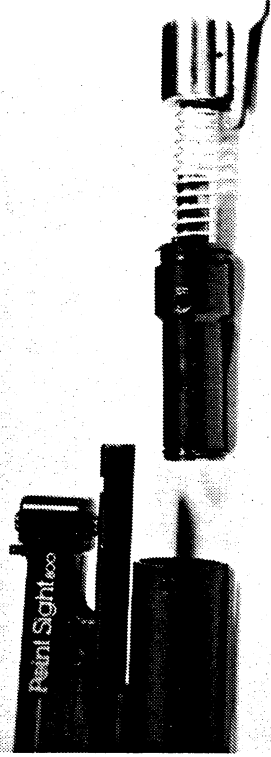

Figure 4

8. For cup seal maintenance remove valve tube assembly as in Figure 5.

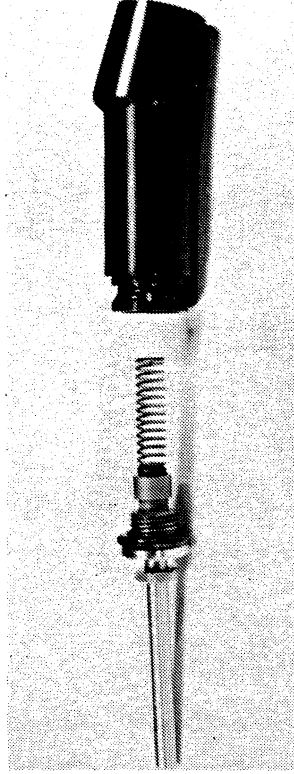

Figure 5

9. When cleaning pieces always use a soft cloth to prevent scratching finished surfaces.
10. Reverse procedure to re-assemble APEX ELITE.

CAUTION: WHEN REASSEMBLING APEX ELITE DO NOT OVER TIGHTEN ANY FASTENERS, SERIOUS THREAD DAMAGE MAY OCCUR.

NOTE

FOR OPTIMUM PERFORMANCE ALWAYS KEEP YOUR BARREL CLEAN AND DRY. BARREL SQUEEGEE AND/OR SWABS ARE RECOMMENDED FOR BORE CLEANING.

LUBRICATE ALL MOVING PARTS WITH A TEFLON TYPE LUBRICANT.
IE: BREAK FREE™, TRI FLOW ETC.

Shock Buffer

The APEX ELITE is equipped with a replaceable shock buffer. The buffer is located below the pump rod. To insure proper performance of your APEX ELITE this part should be checked after every use. If it shows signs of excessive wear replace buffer. (See Figure 2)

The buffer is designed to wear out so that your barrel does not . Proper maintenance of this part will insure the life of your gun. Never shoot your APEX ELITE without the shock buffer. Serious damage can occur.

Adjusting Over Travel

1. Remove receiver screws.

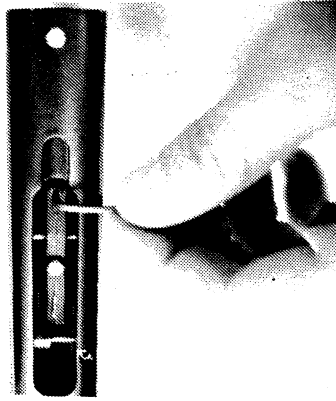

2. Adjust over-travel with an allen wrench. As shown in picture above. Once over-travel is set, lock tight screw in position.

NOTE

OVER TRAVEL IS PRESET AT THE FACTORY FOR OPTIMUM PERFORMANCE. CHANGE THIS SETTING ONLY IF YOU ARE UNHAPPY WITH TRIGGER PULL.

Instructions For Filling CO₂ Cylinders

1. Bulk cylinder with siphon tube and filling adapter required:
 2. Cylinder must be completely empty: to empty, depress valve pin on top of cylinder with small round object until cylinder is completely empty. Do not allow prolonged contact with CO₂ gas discharged from cylinder. Frost bite or cold burns may occur.
 3. Weigh cylinder.
 4. Record empty weight of cylinder.
 5. Chill cylinder by one of the following methods:
 - A) Freezing cylinder in ice.
 - B) Place cylinder in a freezer or refrigerator.
 - C) Bleeding CO₂ slowly from valve.
 6. After cylinder is chilled, connect it to bulk source CO₂;
 7. Crack open valve on bulk cylinder for approximately 15 seconds.
 8. Close valve on bulk cylinder.
 9. Remove cylinder and weigh it.
- FULL WEIGHT - EMPTY WEIGHT = AMOUNT OF CO₂ IN CLYINDER.
- Fill only to specified capacity of cylinder.

CAUTION: DO NOT OVERFILL CYLINDERS. DO NOT EXPOSE CYLINDER TO HEAT OF ANY KIND. CYLINDER MAY RUPTURE CAUSING DAMAGE.

10. Do not fill bottles if you do not have appropriate equipment.
11. Refills may be obtained at your nearest carbon dioxide fire extinguisher dealer or at your local field operator if capable.

APEX ELITE Parts

*Refer to Apex Elite Parts Price List for prices

1. Barrel	22. Cup Seal
2. Sight Base	23. Return Spring
3. Base Screws	24. Adaptor Body
4. NOT APPLICABLE	25. Adaptor Screw
5. Pump	26. Bottle Valve Assembly
6. Pump Screw	27. Bottle O-Ring
7. Shock Buffer	28. Bottle
8. Front Mount with Fastener	29. Butt Plate
9. Mount Fastener	30. NOT APPLICABLE
10. Sling Clips (2)	31. Receiver
11. Sling	32. NOT APPLICABLE
12. Venturi Bolt	33. NOT APPLICABLE
13. Bolt O-Ring	34. Box Loader
14. Main Spring	35. Box Elbow
15. Hammer	36. Regulator Piston
16. Sear Spring	37. Regulator Screw
17. Sear Pin	38. Receiver Grip
18. Sear	39. Grip Screw/Washer
19. Valve Tube	40. NOT APPLICABLE
20. Valve Seat	41. Adaptor Screw
21. Seat O-Ring	42. Front Receiver Screw

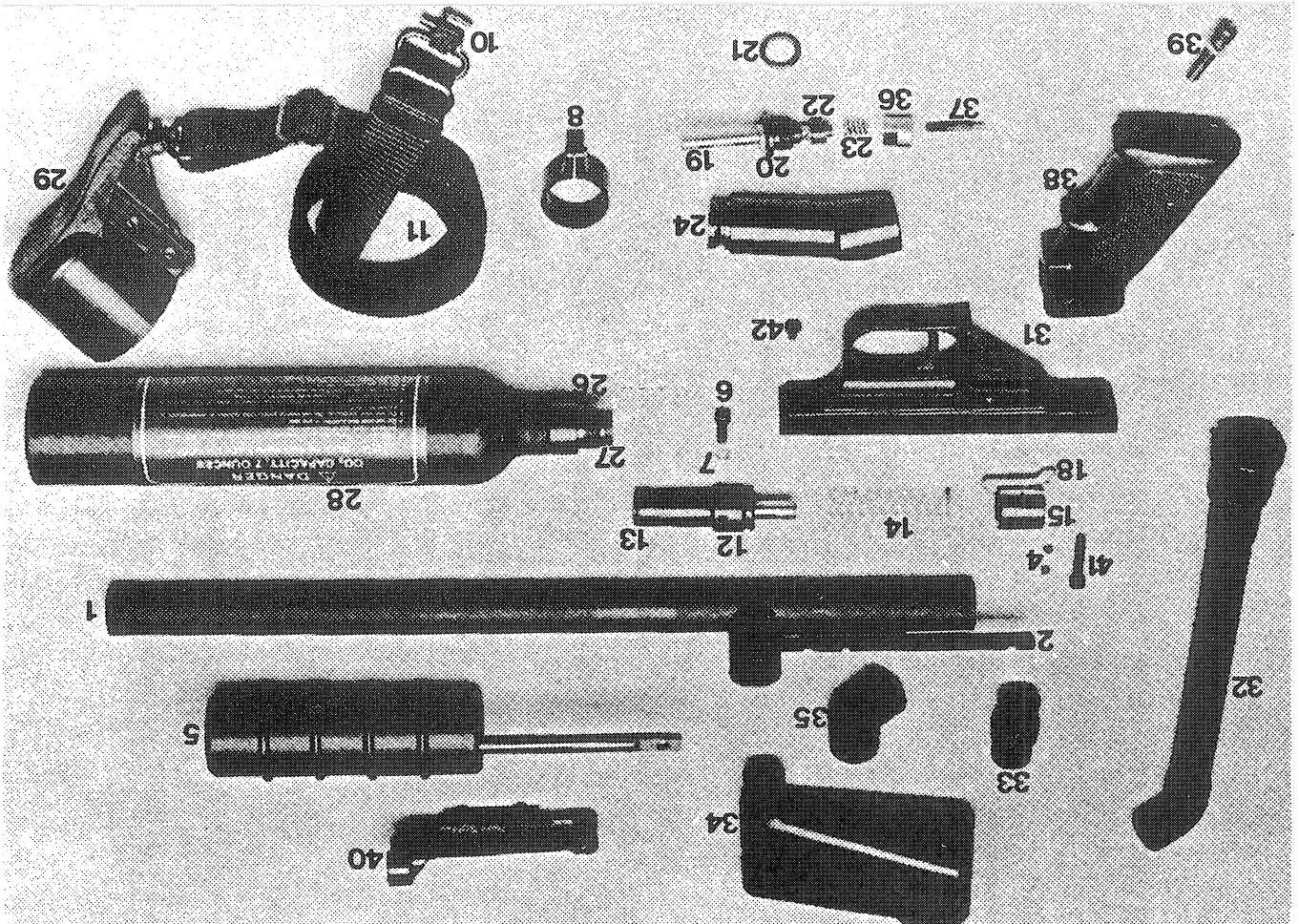

Air Power APEX ELITE

LIMITED WARRANTY

Repair

If your APEX ELITE malfunctions, contact:

Air Power (804) 587-7185

If you require factory repair include a short description of the problem. Include your name, address and telephone number.

Refer to warranty for information regarding factory service.

Air Power pays no freight.

Air Power will repair or replace parts as specified under warranty. Any and all parts replaced under warranty become the property of Air Power.

For orders and parts call:

(800)HIGH-PWR

Refer to parts list included in this manual.

Air Power will repair or replace, at Air Power's option, this product in the event of a defect in materials or workmanship as follows:

Parts

New or rebuilt parts in exchange for defective parts 90 days from the date of original purchase.

Parts not under warranty

Air Power does not warranty o-rings, cup seals, valve tube, CO₂ cylinders or any product not directly manufactured by Air Power.

Labor

Carry in or mail in service for 180 days from date of original purchase.

Carry in or mail in service in the U.S.A. can be obtained during the warranty period from Air Power directly.

This warranty is extended to the original purchaser only.

A purchase receipt or other proof of date of original purchase will be required before warranty performance is rendered.

This warranty does not cover damage which occurs in shipment or failures which are caused by products not supplied by Air Power, or failures which result from accident, misuse, abuse, neglect, mishandling, misapplication, alteration, modification, overloading the product beyond its rated capacity, using the product with an improper accessory or service by other than an authorized Air Power service representative, or damage that is attributed to acts of God.

Limits and Exclusions

There are no other express warranties except as listed above.

Air Power shall not be liable for incidental or consequential damages resulting from the use of this product, or arising out of any breach of this warranty. All express and implied warranties, including the warranties of merchantability and fitness for a particular purpose, are limited to the applicable warranty period set forth above.

This warranty gives you specific legal rights, and you may have other rights which vary from state to state.

If a problem arises with the product always contact Air Power (804) 587-7185.



7425 Sewells Point Road, Suite E
Norfolk, Virginia 23513-1755
(804)587-7185 For Info
(800) HIGH-PWR Orders Only
FAX (804)587-7706